

METHOD STATEMENT PAVISOL

The installation of PAVISOL could be done by any screeding company after our instructions, basically this procedure will not require specialists.

Instructions on how to apply our under-flooring materials,

1st option Simplified scheme
 CERAMIC / STONE FLOORING / RESILIENT / CARPETING

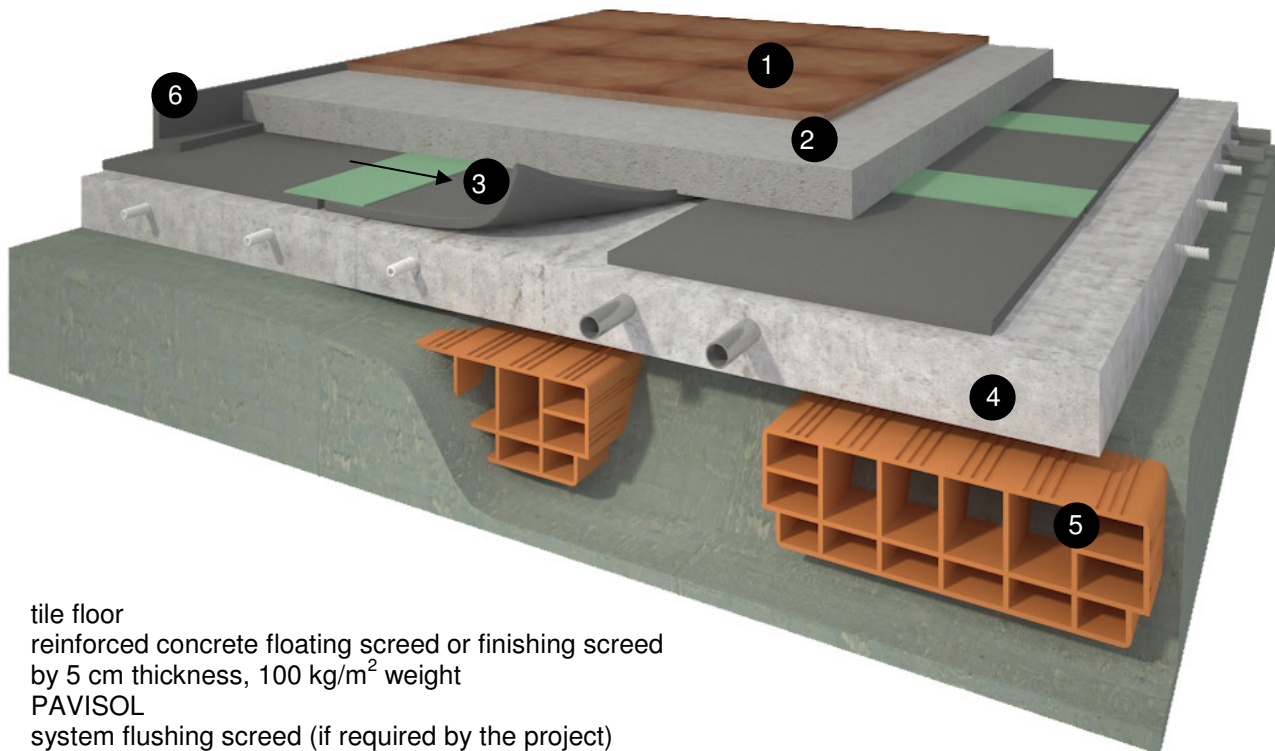

1. tile floor
2. reinforced concrete floating screed or finishing screed by 5 cm thickness, 100 kg/m² weight
3. PAVISOL
4. system flushing screed (if required by the project)
5. concrete sub-floor Slab.
6. fascia perimetrale (Perimetral seal/strip), thickness 3

PAVISOL is recommended whenever higher acoustic comfort and impact noise resistance are required.

Here down the typical installation system:

1. place the PAVISOL (no. 3) starting from the edge of the existing subfloor (no 5) or the flushing screed system (no 4) if this last exists
2. unroll the PAVISOL on the screed (no. 4 or 5)
3. the roll once it's laid on the floor has to be butt jointed and sealed through a sealing tape
4. cut and remove any residual product on the wall edges through a cutter
5. place the Perimetral strip (no. 6) by 15/20 cm on the edge between the wall and the floor, then stick 5 cm on the floor base and the others will be used against the wall.
6. cast-in-place the cement (no. 2) to build the second screed upon the Pavisol
7. once the cement is dried, place the floor no 1 (ex: tiles etc) keeping it separated from the perimetral walls thanks by the Pe foam strip already positioned at the point no 5. This is to avoid causing any acoustic bridges.

2st option Simplified scheme
FLOATING WOOD FLOOR

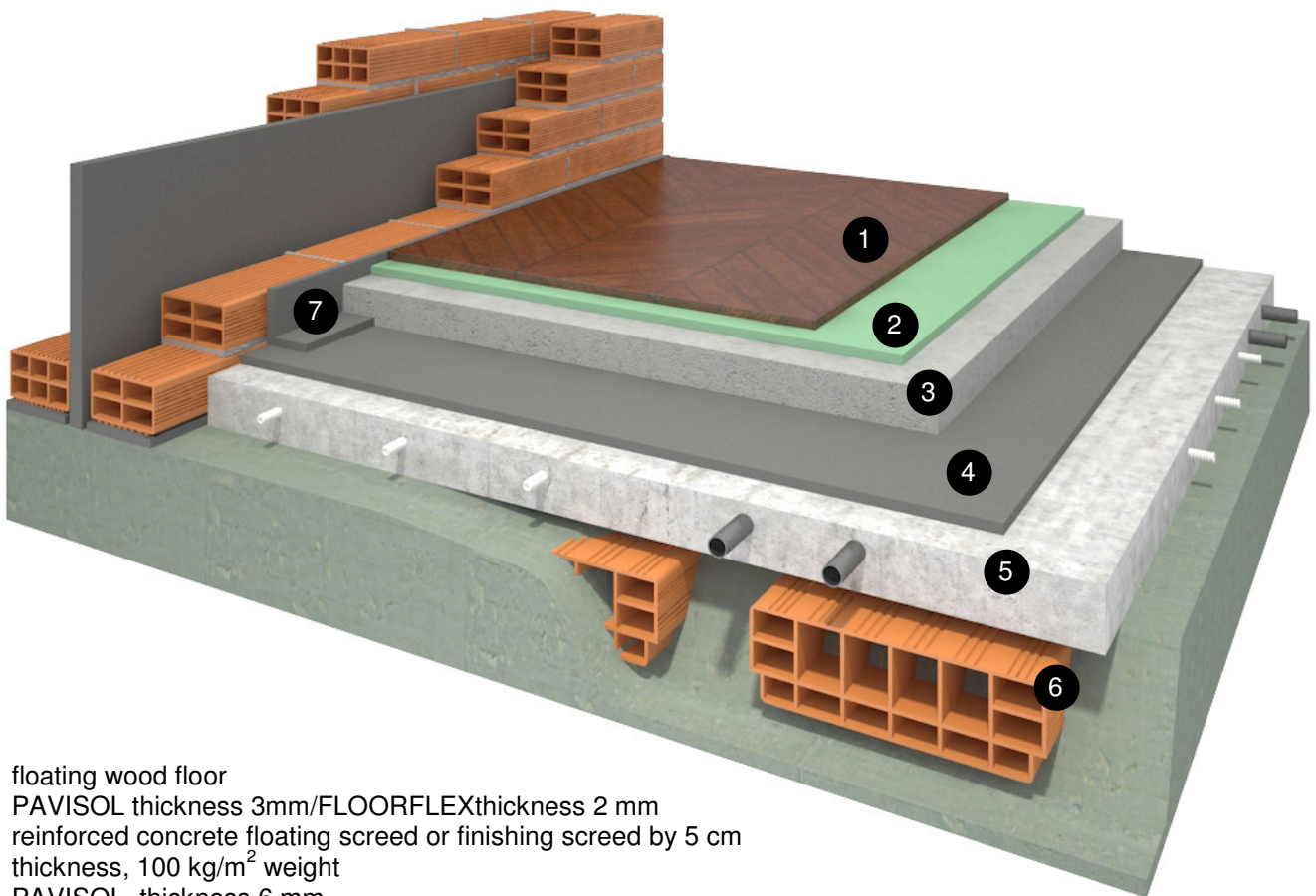

1. floating wood floor
2. PAVISOL thickness 3mm/FLOORFLEX thickness 2 mm
3. reinforced concrete floating screed or finishing screed by 5 cm thickness, 100 kg/m² weight
4. PAVISOL, thickness 6 mm,
5. system flushing screed (if required by the project)
6. concrete subfloor
7. Fascia perimetrale, thickness 3 mm

Piero / pow